

3M

Littmann®  
Brand

## Select Stethoscope

---

- Reliable and clear acoustics
- Lightweight, durable design
- Patented tunable diaphragm for monitoring low and high frequencies
- Single-lumen tubing



## **3M™ Littmann® Select Stethoscope**

Congratulations on the purchase of your new Littmann Select Stethoscope.

The Littmann Select stethoscope offers a convenient, tunable diaphragm in a single-sided, coated alloy chestpiece designed to provide reliable and clear acoustics.

The stethoscope offers the portable convenience of a single-sided chestpiece. A patented tunable diaphragm conveniently alternates between low and high frequency sounds without the need to turn over the chestpiece.

Other features include a comfortably angled, anatomically correct headset and single-lumen tubing in a variety of colors to meet individual preferences.

Most of all, know that your Littmann Select stethoscope carries the Littmann brand name, the name known worldwide for unsurpassed quality. As a trusted leader in auscultation technology, the Littmann brand of stethoscopes is your assurance of acoustical superiority, innovative design and exceptional performance.

## Instructions for Use

### Changing Frequencies Using the Tunable Diaphragm

Your Littmann Select Stethoscope is equipped with a patented tunable diaphragm that enables you to listen to both low and high frequency sounds without turning over the chestpiece.

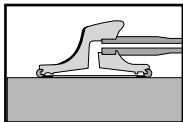

*Low frequencies:* To listen to low frequency sounds (traditional bell mode) use very light skin contact.

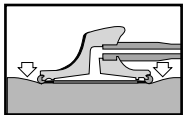

*High frequencies:* To listen to higher frequency sounds (traditional diaphragm mode), press firmly on the chestpiece.

To listen to low and high frequency sounds without removing and repositioning the chestpiece simply alternate between light and firm pressure on the chestpiece.

### Headset Adjustment

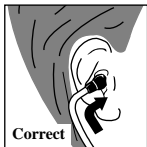

Your new Littmann stethoscope is designed to provide a comfortable, acoustically sealed ear fit. Notice that the eartubes are set to accommodate the typical anatomy of the ear canal. The eartips should point

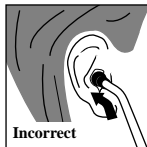

in a forward direction as you insert them into your ear canals.

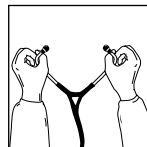

To reduce spring tension in the headset, hold each eartube at the bend near the eartip and gradually pull apart until fully extended.

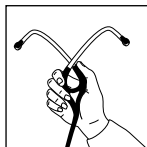

To increase spring tension, grasp the headset with one hand where the eartubes enter the tubing and squeeze until the tubing on one eartube touches the other. Repeat as necessary.

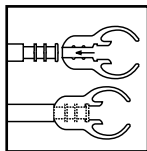

This stethoscope utilizes a unique design for attaching the eartip to the eartube. The eartips are pushed on to the end of the eartube and snapped firmly into place. To remove, pull firmly on the eartip.

## Removing the Diaphragm and Cleaning the Chestpiece

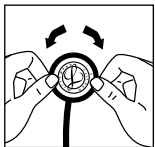

With the diaphragm side up, grasp the rim with the thumbs and index fingers of both hands and roll the rim off the edge of the chestpiece.

Remove the diaphragm from the rim and clean the parts in

soapy water or wipe with alcohol. Chestpiece surfaces can be wiped with alcohol or soapy water. Dry all parts and surfaces thoroughly before reassembly.

## Assembly and Replacement of the Tunable Diaphragm

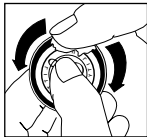

Using your fingertip, apply a small amount of talcum powder to the inside surface of the flexible edge of the diaphragm. This will facilitate assembly and maintain smooth and quiet

low/high frequency alternation. Snap the diaphragm with your fingers to remove excess talc.



Insert the flexible edge of the diaphragm into the groove of the rim. This is best accomplished by starting with the rim positioned above the legible side of the diaphragm.

Visually examine the ring to ensure that the flexible edge is smoothly engaged inside the rim. If necessary, flex the assembly by pinching the outer rim edge

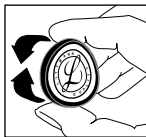

between the thumb and fingers. Repeat this flexing procedure after rotating the assembly one quarter.

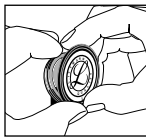

To attach the rim/diaphragm assembly to the chestpiece, engage the groove of the rim (with the diaphragm attached) around the chestpiece at one point and hold it in place with your thumbs.

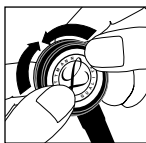

Slowly roll the rim around and over the chestpiece edge using both thumbs, moving in opposite directions around the chestpiece.

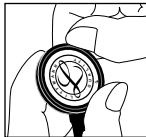

Visually inspect the edge where the diaphragm engages the rim for uniform containment. Minor adjustments may be made by slightly pulling and rolling the rim away from the diaphragm, allowing the diaphragm to slip into position.

## General Use and Maintenance

- Avoid extreme heat, cold, solvents, and oils.
- The entire stethoscope can be wiped clean with alcohol or soapy water.

- Eartips can be removed from the eartubes for thorough cleaning.

NOTE: Do not immerse your stethoscope in any liquid or subject it to steam sterilization. If disinfection is required, the stethoscope may be wiped with a 70% isopropyl alcohol solution.

## Littmann Stethoscope Service and Warranty Program

Your Littmann stethoscope comes with the finest service and warranty policy in the industry. The Littmann Select Stethoscope is warranted against any defects in material and workmanship for a period of two (2) years. If a material or manufacturing defect is discovered during the warranty period, repairs will be made without charge upon the return of the instrument to 3M, except in cases of obvious abuse or accidental damage.

For maintenance or repair services, write a short note explaining the repair or service you require, include your name, address and phone number and send your stethoscope directly to:

3M Health Care Service Center  
Bldg. 502, Suite 200  
3350 Granda Ave. North  
Oakdale, MN 55128  
1-800-292-6298

IN CANADA:

3M Health Care Service Centre  
3M Canada Inc.  
80 Enterprise Drive South  
London, Ontario  
Canada N6N1C2  
1-800-563-2921

Outside of the U.S. and Canada please contact your local 3M subsidiary for maintenance and repair information.

## Explanation of Symbols:



- Attention, see instructions for use.



- This product and package do not contain natural rubber latex.



Made in USA by **3M Health Care**, St. Paul, MN 55144-1000  
(U.S.A.) 1-800-228-3957 • Fax 651-736-2803  
Visit our web site: <http://www.3M.com/Littmann>

**CE**  Attention, see instructions for use.  
**3M Health Care** D-41453 Neuss, Germany

3M is a trademark of 3M.  
Littmann is a registered trademark of 3M.

38-9018-0773-5